

**GENERAL NOTES:**

- FIELD VERIFY DIMENSIONS PRIOR TO BIDDING
- PROVIDE 20 YEAR NDL WARRANTY
- REPLACE 50 % OF 3/4" PLYWOOD DECKING. FIELD VERIFY. REVIEW WITH ARCHITECT PRIOR TO DEMO.

Timothy M. Brandon  
 Architect APC  
 103 Cypress Street  
 West Monroe, LA 71291  
 Tel. 318.340.1550  
 Fax. 318.998.1315  
 www.tbastudio.com

**TBFA**

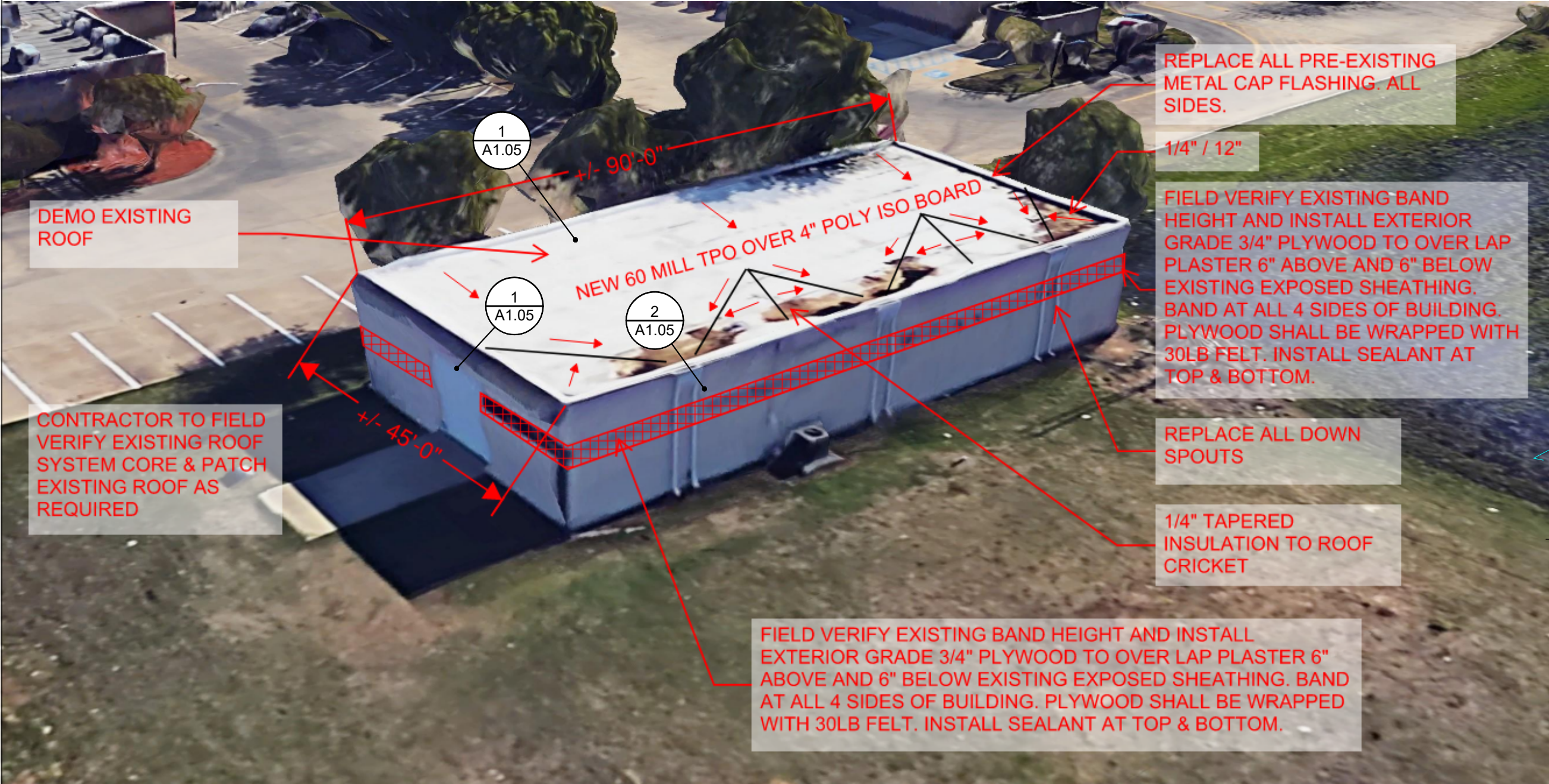

DEMO EXISTING ROOF

CONTRACTOR TO FIELD VERIFY EXISTING ROOF SYSTEM CORE & PATCH EXISTING ROOF AS REQUIRED

REPLACE ALL PRE-EXISTING METAL CAP FLASHING. ALL SIDES.

1/4" / 12"

FIELD VERIFY EXISTING BAND HEIGHT AND INSTALL EXTERIOR GRADE 3/4" PLYWOOD TO OVER LAP PLASTER 6" ABOVE AND 6" BELOW EXISTING EXPOSED SHEATHING. BAND AT ALL 4 SIDES OF BUILDING. PLYWOOD SHALL BE WRAPPED WITH 30LB FELT. INSTALL SEALANT AT TOP & BOTTOM.

REPLACE ALL DOWN SPOUTS

1/4" TAPERED INSULATION TO ROOF CRICKET

FIELD VERIFY EXISTING BAND HEIGHT AND INSTALL EXTERIOR GRADE 3/4" PLYWOOD TO OVER LAP PLASTER 6" ABOVE AND 6" BELOW EXISTING EXPOSED SHEATHING. BAND AT ALL 4 SIDES OF BUILDING. PLYWOOD SHALL BE WRAPPED WITH 30LB FELT. INSTALL SEALANT AT TOP & BOTTOM.

SHEET

DESCRIPTION:  
 ROOF PLAN



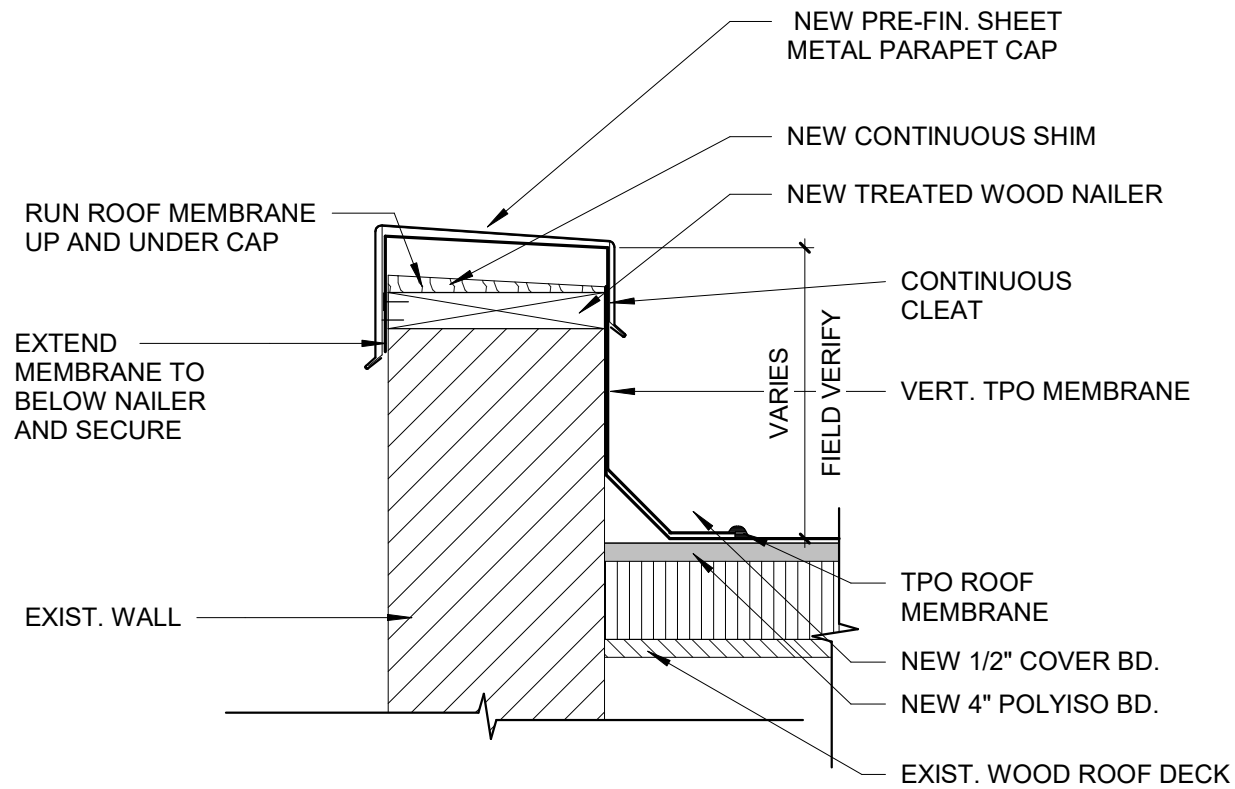

1 ROOF DRAIN TYP.  
 1 1/2" = 1'-0" | RE:1/A1.04

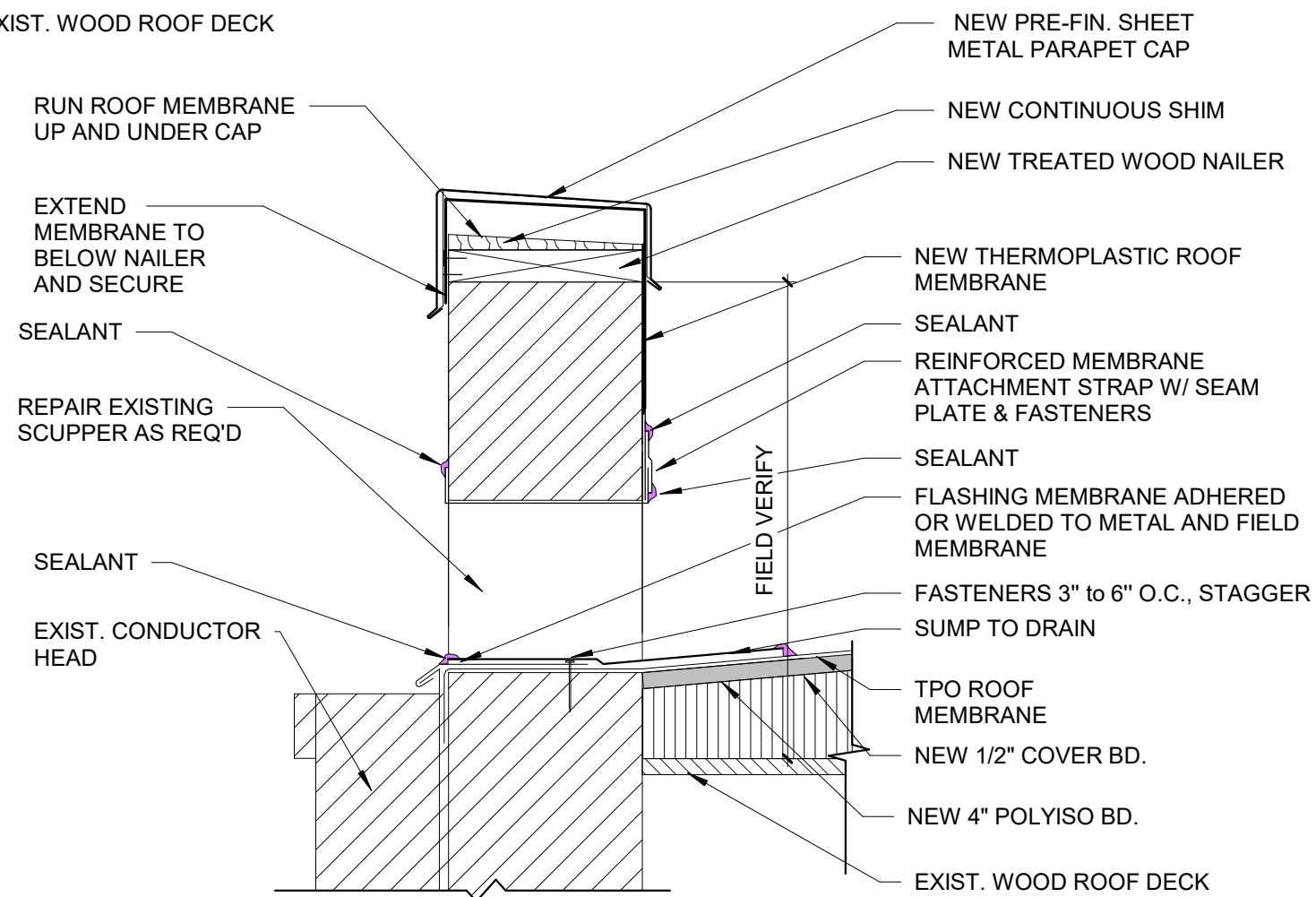

2 ROOF DRAIN TYP.  
 1 1/2" = 1'-0" | RE:1/A1.04

Timothy M. Brandon  
 Architect APC  
 103 Cypress Street  
 West Monroe, LA 71291  
 Tel. 318.340.1550  
 Fax. 318.998.1315  
 www.tbastudio.com

**TBA**

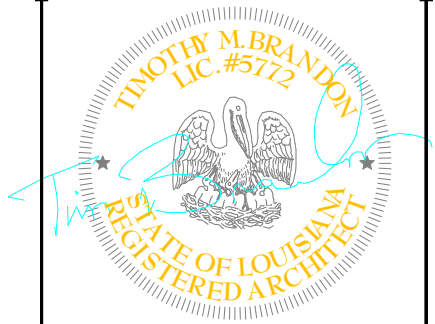

SHEET

DESCRIPTION:  
 ROOF DETAILS